

Thermal Memory Ltd

6 Dodd Croft
Rochdale OL16 4QX
Gtr. Manchester
Great Britain

Website : www.shrinkfit.co.uk E-mail : shrinkfit@gmail.com

SNAP2LOCK Shell Design Features

Fully Tested	Type testing according to BS 7888-3:1998 BS6910 Part 1, 1988 DIN VDE0278-623:1997-01
Quality/Certification	Assessed for quality Assurance To meet the requirements of BS EN ISO 9002
Straight Through & Branch Joints up to 400mm ²	All standard joints are supplied as complete in a single carton. Each Kit comprises of a clear plastic shell, armour bond, a two part polyurethane resin compound, gloves and jointing instructions.
Connectors	Joint Kits also available with mechanical connectors or crimp ferrules.
No Special Jointing Skills	Jointing is easy, instructions are provided with each joint.
Working Space	Choice of SNAP2LOCK or larger Shell to provide even more working space.
Armour Bond Kit	Can be customised to suit individual needs.
No Heat required	Joints are filled with a 2 part high quality polyurethane resin compound which is supplied in a 2 section self contained non perishable bag enclosing both resin and hardener ensuring safety, no contact with skin.
No further protection	The resin compound penetrates and sets solid within a plastic shell which effectively insulates seals and protects the joint, it will not subsequently soften.
Shelf Life	Resin stored in a well ventilated and dry area between 10 to 25°C.
Effective under fault conditions	Tough resin encapsulation ensures full symmetric fault capability, while earth bonds are sized to give full cable earth fault performances.
Suitability	600/1000V cables with stranded copper or solid aluminium conductors up to 400 sq mm PVC > LPE or EPR insulated. PILC PVC sheathed single wire armoured aluminium strip armoured or un-armoured.

We recommend that all equipment is installed on De-energised Cables. The equipment detailed in this publication should only be installed by a suitably qualified person.



Thermal Memory Ltd

6 Dodd Croft
Rochdale OL16 4QX
Gtr. Manchester
Great Britain

Website : www.shrinkfit.co.uk E-mail : shrinkfit@gmail.com

SNAP2LOCK

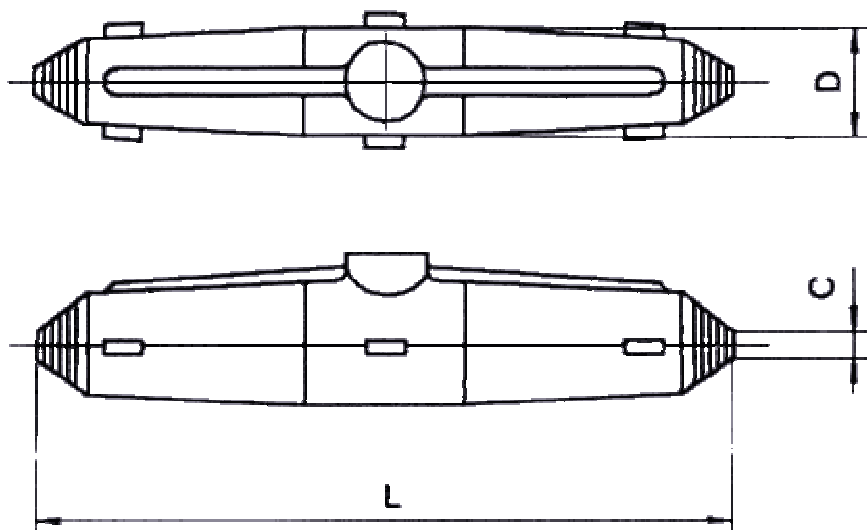

Dimensions

Joint Types	L (mm)	D (mm)	C (mm)	Resin Content
Straight 6	189	40	6 - 28	200ml
Straight 16	275	50	12 - 32	450ml
Straight 35/70	355	72	26 - 45	1,200ml
Straight 120	547	108	37 - 67	4 litres
Straight 185	800	32	48 - 88	10 litres